

# DSB01i

## Digital Load cells 数字称重传感器

### Special features 特点

- Digital output signal (RS-485/4-wire)
- Nominal(rated) loads: 10t...40t
- Self restoring
- Laser welded, IP68
- Simple to install
- Inbuild overvoltage protection
- 数字信号输出 (RS485/四线制)
- 额定量程范围: 10t ~ 40t
- 自复位钢球压头结构
- 激光焊接IP68
- 安装简便
- 内置过电压保护

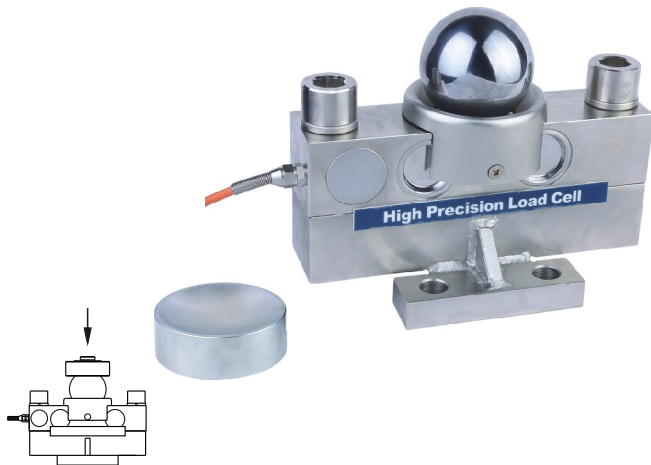

汽车衡、轨道衡、轴量秤及各种专用衡器  
Truck scale, railway scale, hopper scale, and other special weighing apparatus

### Dimensions and Accessories 尺寸和附件 (in mm; 1 mm=0.03937 inches)

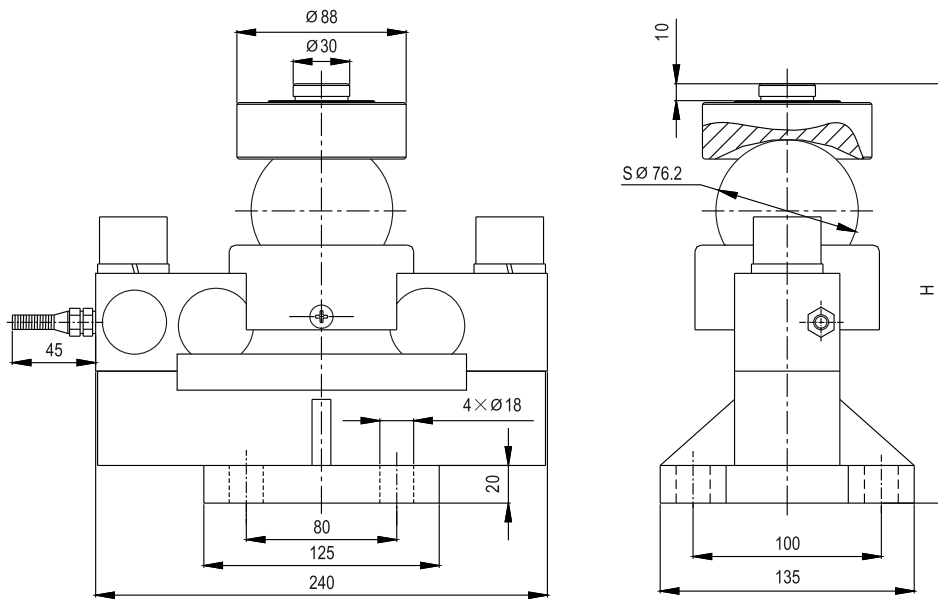

Emax[t]	H
10,15,20,25,30	224.8
40	230.8

### Wiring code 配线

GND 地线	black 黑色
VCC 电源	red 红色
RB(RX+) 接收正	green 绿色
RA(RX-) 接收负	white 白色
TB(TX+) 发送正	blue 蓝色
TA(TX-) 发送负	Yellow 黄色

### Maxium Transmitting Distance 最大传输距离

单根导线截面积(mm) <sup>2</sup>	0.12	0.3	0.5	0.8	1	1.2
最大传输距离(m)	110	270	450	730	910	1000

## Specifications 技术说明

Item 项目	Unit 单位	Parameter 参数					
Accuracy class to OIML R 60 精度等级		C 1			C 3		
<b>Maximum capacity (E<sub>max</sub>) 额定载荷</b>	<b>t</b>	<b>10,15,20,25,30,40</b>					
Minimum LC verification interval (V <sub>min</sub> ) 最小检定分度值	% of E <sub>max</sub>	0.0200			0.0100		
<b>Sensitivity (C<sub>n</sub>) 灵敏度</b>	<b>digit</b>	<b>1 000 000</b>					
Temperature effect on zero balance (TK <sub>0</sub> ) 温度对零点影响	% of C <sub>n</sub> /10K	±0.02			±0.0170		
Temperature effect on sensitivity (TK <sub>c</sub> ) 温度对灵敏度影响	% of C <sub>n</sub> /10K	±0.02			±0.0170		
Hysteresis error (d <sub>hy</sub> ) 滞后误差	% of C <sub>n</sub>	±0.0270			±0.0180		
Non-linearity(d <sub>lin</sub> ) 非线性误差	% of C <sub>n</sub>	±0.0250			±0.0167		
Creep(d <sub>cr</sub> ) over 30 min. 蠕变及蠕变恢复	% of C <sub>n</sub>	±0.030			±0.0167		
Current consumption 电流损耗	mA	<21					
Baudrate 波特率	Baud	9600					
Number of bus addresses 总线地址数		max.32					
<b>Nominal range of excitation voltage (B<sub>u</sub>) 额定电压</b>	<b>V(DC)</b>	<b>7~12</b>					
Asynchrone Interface 异步接口		RS485/4-Wire					
Service temperature range (B <sub>tu</sub> ) 工作温度	°C	-20...+60					
Safe load limit (E <sub>L</sub> ) & Break load(E <sub>d</sub> ) 安全承载&破坏载荷	% of E <sub>max</sub>	150 & 300					
<b>Protection class according to EN 60 529 (IEC 529) 保护等级</b>		<b>IP68</b>					
Material :Measuring element 材料: 弹性体 Cable fitting 电缆配件/Cable-sheath 电缆护套		Stainless or alloy steel Stainless steel /PVC					
Maximum capacity (E <sub>max</sub> ) 额定载荷	t	10	15	20	25	30	40
Min. scale verification (e <sub>min</sub> ) according to EN 45 501 [...#]=max. Number of load cells 秤的最小检定分度值	kg	5 [6#]	5 [6#]	5 [6#] 10 [8#]	10 [8#]	10 [8#]	10 [6#] 20 [8#]
Recommended maximum weighing capacity of scale 推荐秤的额定载荷	t	20	30	50 80	80	100	120 150
Deflection at E <sub>max</sub> (s <sub>nom</sub> ) ,approx 最大载荷下的变形量	mm	<0.55					
Weight(G),approx 重量	kg	15.5	16			16.5	
Cable 电缆: Diameter 直径:∅6mm Length长度	m	8	10	12/15		16	

## Wiring code with computer 与电脑连接方式

