

BL02

Load cells 称重传感器

BL02:10kg...500kg

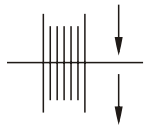
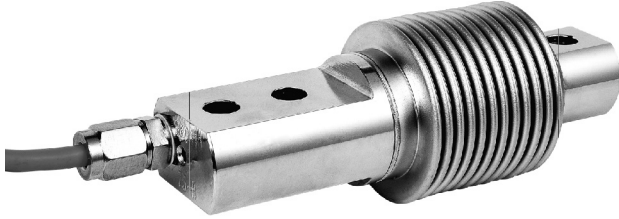

料斗秤、皮带秤、配料系统
Oppe r scale,belt scale,blending system

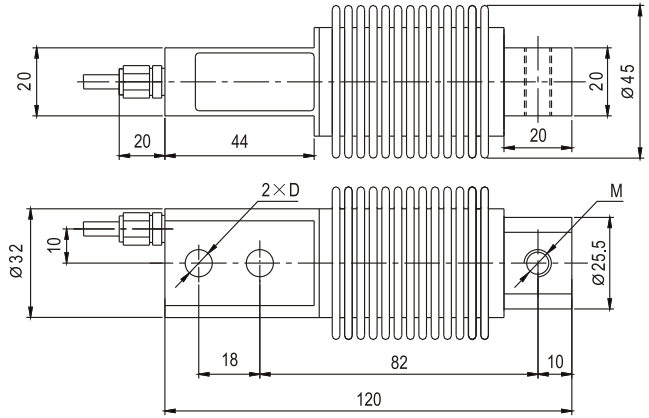

Emax[kg]	D	M
10,20,50,75,100,200,250	ø 8.2	M8
300,500	ø 10.2	M10

Specifications 技术说明 Exc+激励正 (Red,红);Exc-激励负(Black,黑);Sig+信号正(Green,绿);Sig-信号负(White,白)

Item 项目	Unit 单位	Parameter 参数	
Accuracy class to OIML R 60 精度等级		C2	C3
Maximum capacity (Emax) 额定载荷	kg	10,20,50,75,100,200,250,300,500	
Minimum LC verification interval (Vmin) 最小检定分度值	% of Emax	0.0200	0.0100
Sensitivity (Cn) / Zero balance 灵敏度/零点平衡	mV/V	2 ± 0.002 / 0 ± 0.02	
Temperature effect on zero balance (TKo) 温度对零点影响	% of Cn/10K	±0.02	±0.0170
Temperature effect on sensitivity (TKc) 温度对灵敏度影响	% of Cn/10K	±0.02	±0.0170
Hysteresis error (d _{hy}) 滞后误差	% of Cn	±0.0270	±0.0180
Non-linearity(d _{lin}) 非线性误差	% of Cn	±0.0250	±0.0167
Creep(d _{cr}) over 30 min. 蠕变及蠕变恢复	% of Cn	±0.0233	±0.0167
Input (RLC) & Output resistance (Ro) 输入&输出电阻	Ω	400 ± 10 & 352 ± 3	
Nominal range of excitation voltage (Bu) 额定电压	V	5~12	
Insulation resistance (Ris) at 50Vdc 绝缘电阻	MΩ	≥5000	
Service temperature range (B _{tu}) 工作温度	℃	-30...+70	
Safe load limit (EL) & Break load(Ed) 安全承载&破坏载荷	% of Emax	150 & 200	
Protection class according to EN60529 (IEC 529) 保护等级		IP68	
Material :Measuring element 材料: 弹性体 Cable fitting 电缆配件 Cable-sheath 电缆护套		Stainless or alloy steel Stainless steel or nickel-plated brass PVC	

Maximum capacity (Emax) 额定载荷	kg	10	20	50	75	100	200	250	300	500
Deflection at Emax (s _{nom}), approx 最大载荷下的变形量	mm	0.29							0.39	
Weight(G), approx 重量	kg	0.5								
Cable 电缆: Diameter 直径: ø5mm Length 长度	m	3								