

TS01/TS02

Load cells 称重传感器

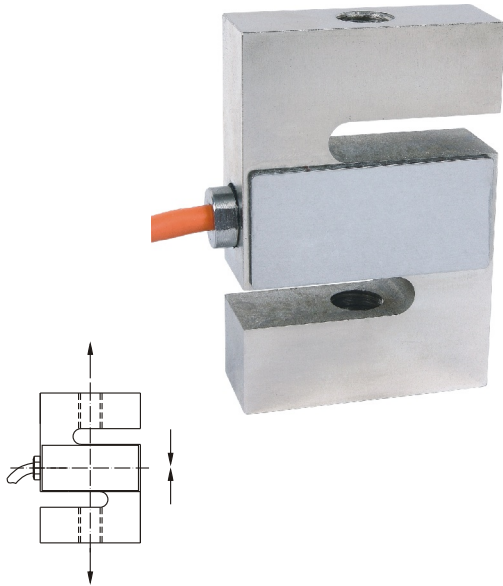

吊钩秤、皮带秤、配料系统
Hoop scale, strap scale, blending system

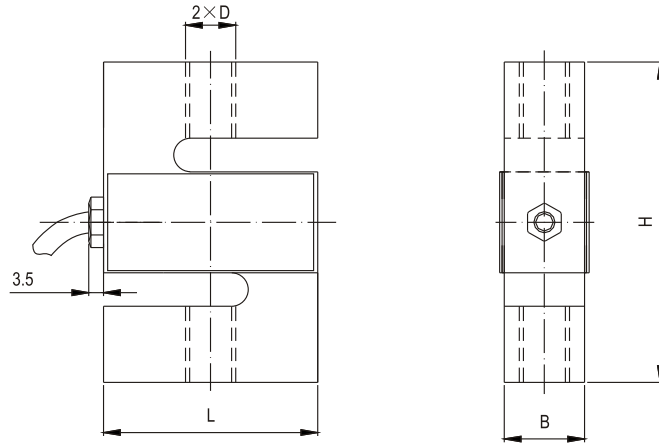

Emax[t]	H	L	B	D
0.1,0.2,0.25,0.3,0.5	76.2	51	19.1	M12
1	76.2	51	25.4	M12
2,3,5	100.4	76.2	31.8	M20×1.5

Specifications 技术说明 Exc+激励正 (Red,红);Exc-激励负(Black,黑);Sig+信号正(Green,绿);Sig-信号负(White,白)

Item 项目	Unit 单位	Parameter 参数	
Accuracy class to OIML R 60 精度等级		C2	C3
Maximum capacity (Emax) 额定载荷	t	0.1,0.2,0.25,0.3,0.5,1,2,5	
Minimum LC verification interval (Vmin) 最小检定分度值	% of Emax	0.0200	0.0100
Sensitivity (Cn) 灵敏度	mV/V	TS01:3.0±0.003 / TS02:2.0±0.002	
Zero balance 零点平衡	mV/V	TS01:0±0.03 / TS02:0±0.02	
Temperature effect on zero balance (TK0) 温度对零点影响	% of Cn/10K	±0.02	±0.0170
Temperature effect on sensitivity (TKc) 温度对灵敏度影响	% of Cn/10K	±0.02	±0.0170
Hysteresis error (d _{hy}) 滞后误差	% of Cn	±0.0270	±0.0180
Non-linearity(d _{lin}) 非线性误差	% of Cn	±0.0250	±0.0167
Creep(d _{cr}) over 30 min. 蠕变及蠕变恢复	% of Cn	±0.030	±0.0167
Input (RLC) & Output resistance (Ro) 输入&输出电阻	Ω	400±10 & 352±3	
Nominal range of excitation voltage (Bu) 额定电压	V	5~12	
Insulation resistance (Ris) at 50Vdc 绝缘电阻	MΩ	≥5000	
Service temperature range (B _{tu}) 工作温度	°C	-30...+70	
Safe load limit (EL) & Breaking load (Ed) 安全承载&破坏载荷	% of Emax	120 & 200	
Protection class according to EN 60 529 (IEC 529) 保护等级		0.1t~1t:IP67;2t~5t:IP68	
Material :Measuring element 材料: 弹性体 Cable fitting 电缆配件 Cable-sheath 电缆护套		Stainless or alloy steel Stainless steel or nickel-plated brass PVC	

Maximum capacity (Emax) 额定载荷	t	0.1,0.2,0.25,0.3,0.5	1	2	3	5
Deflection at Emax (snom) ,approx最大载荷下的变形量	mm	0.15	0.25	0.45		
Weight(G),approx 重量	kg	0.6	0.8	1.5		
Cable 电缆: Diameter 直径: ∅5mm Length长度	m	3	5			